

16 Hind Place

BourkeRise

Heyfield



16 Hind Place Heyfield VIC

4 2 2

Welcome to Your Dream Home at 16 Hind Place, Heyfield, perfect for buyers looking to downsize or the astute investor.

Nestled in the prestigious Bourke Rise, just a stone's throw away from the Heyfield town centre, this stunning property offers the epitome of modern living. Boasting a fantastic layout with 4 bedrooms and 2 bathrooms, it's the perfect blend of comfort and style.

Step inside and be greeted by open-plan living, seamlessly connecting the kitchen, dining, and lounge spaces. With 2700mm ceilings and LED lights throughout, every corner exudes an air of sophistication and elegance.

Type : House
Price : \$480,000
Land Size : 455 sqm
View : <http://www.oneagencylv.com.au/sale/vic/gip-psland/heyfield/residential/house/8020771>



Anthony Bloomfield
03 5174 2740

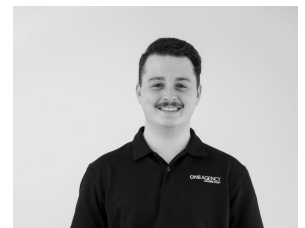

Josh Quigley
03 5174 2740

[For full version visit the website](http://www.oneagencylv.com.au)

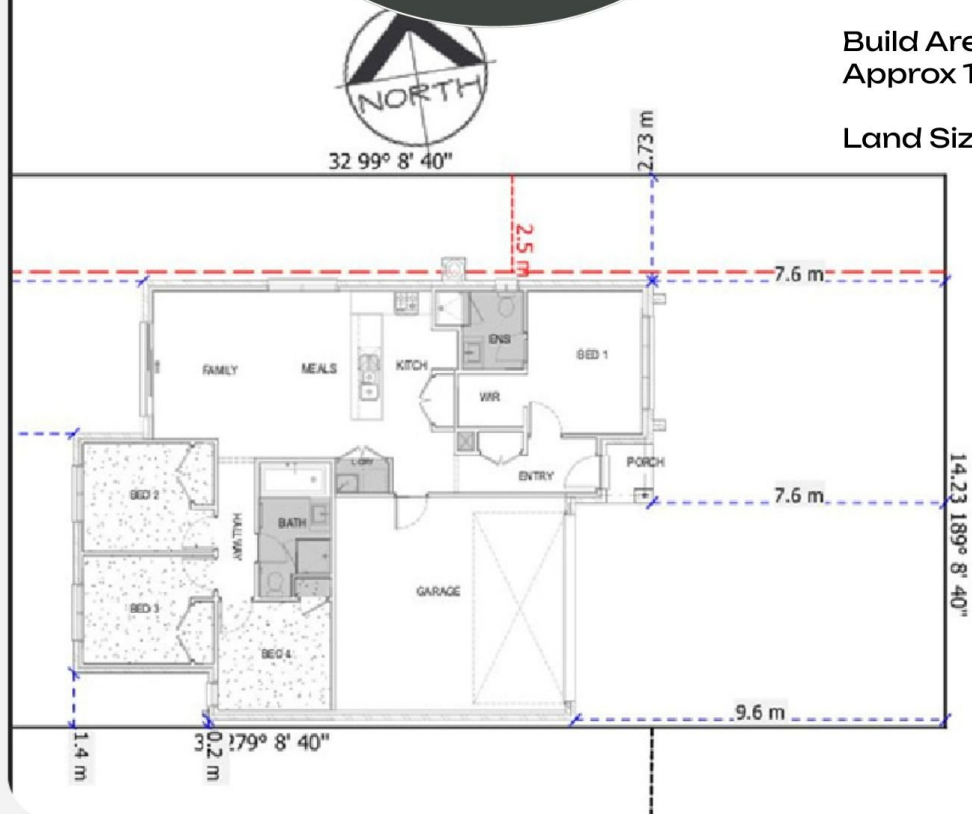

Build Area 147m2
Approx 16 Squares

Land Size 455m2