

7 Hind Place

BourkeRise

Heyfield



7 Hind Place Heyfield VIC

3 2 2

Welcome to Your Dream Home at 7 Hind Place, Heyfield, perfect for buyers looking to downsize or the astute investor.

Nestled in the prestigious Bourke Rise, just a stone's throw away from the Heyfield town center, this stunning property offers the epitome of modern living. Boasting a fantastic layout with 3 bedrooms and 2 bathrooms, it's the perfect blend of comfort and style.

Step inside and be greeted by open-plan living, seamlessly connecting the kitchen, dining, and lounge spaces. With 2700mm ceilings and LED lights throughout, every corner exudes an air of sophistication and elegance.

Entertain with ease in your gourmet kitchen, complete with dishwasher and built in pantry making for effortless meal

Price : \$465,000
Land Size : 384 sqm
View : <http://www.oneagencylv.com.au/sale/vic/gip-psland/heyfield/residential/house/8020772>



Anthony Bloomfield
 03 5174 2740

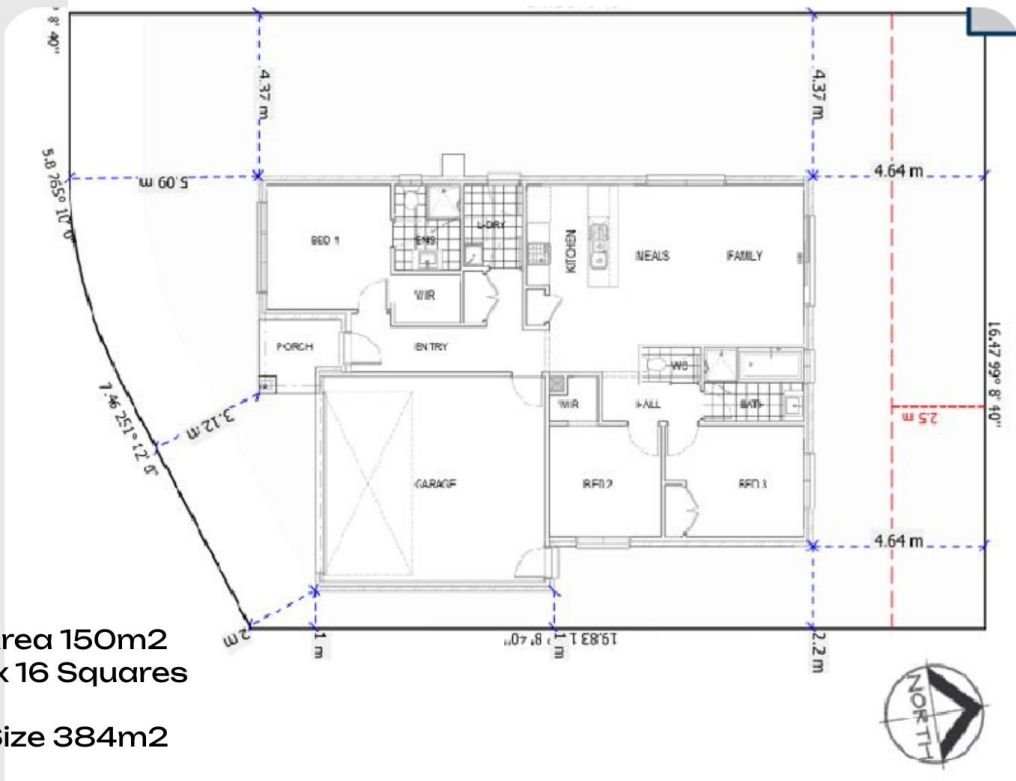

Build Area 150m²
Approx 16 Squares

Land Size 384m²